



COMUNE DI PADOVA
AREA LL.PP.

Settore Edilizia Pubblica e Impianti Sportivi

ELENCO ANNUALE ANNO 2017
PROGETTO ESECUTIVO
TEATRO VERDI
RESTAURO DELLE FACCIATE SUD-EST
E DELLA STATUARIA SOMMITALE

IMPORTO COMPLESSIVO: € 150.000,00

N° Progetto	CCP	Elaborato	10
Nome File	LL.PP.	STATO DI FATTO	
Data	EDP 2017/044	DOCUMENTAZIONE FOTOGRAFICA	
Progettisti	Rup	CAPITOLI (OR. C1-C2-C3-C4)	
Arch. Domenico La Russa	Arch. Domenico La Russa	Arch. Ludovico Gennaro	Arch. Ludovico Gennaro
Arch. Flavia Pavesi			
Arch. Fabio Fozzo			

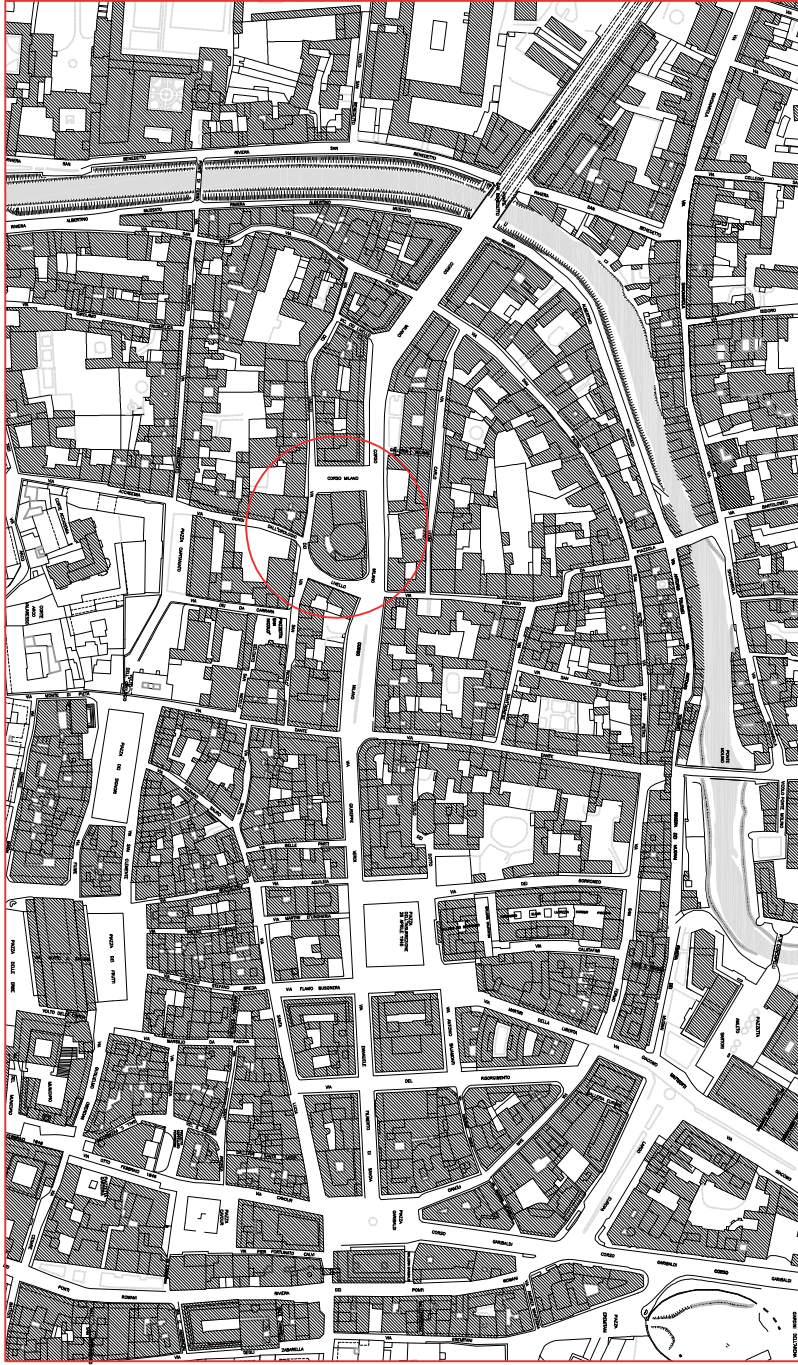

Estratto CTR

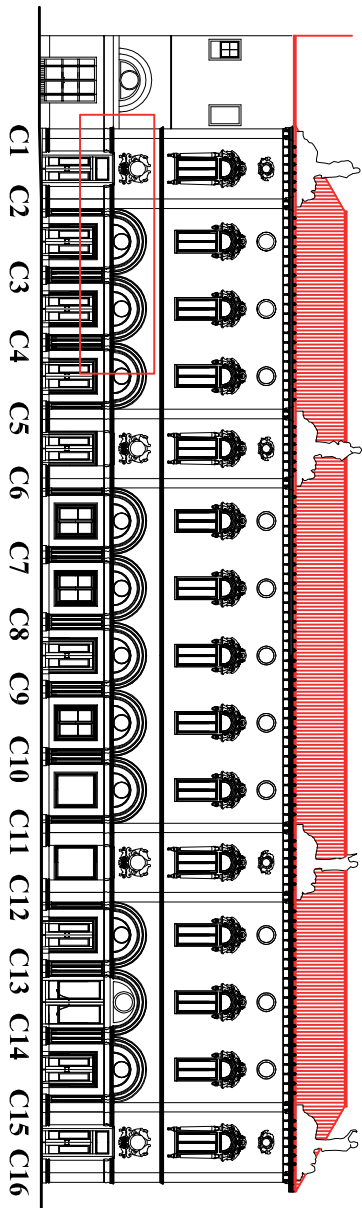
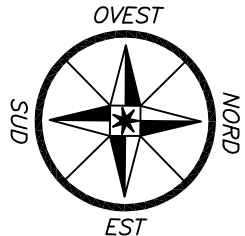

C1.1



C2.1



C3.1



C4.1



C1.2



C2.2



C3.2



C4.2



C1.3



C2.3



C3.3



C4.3



C2.4



C3.4



C4.4

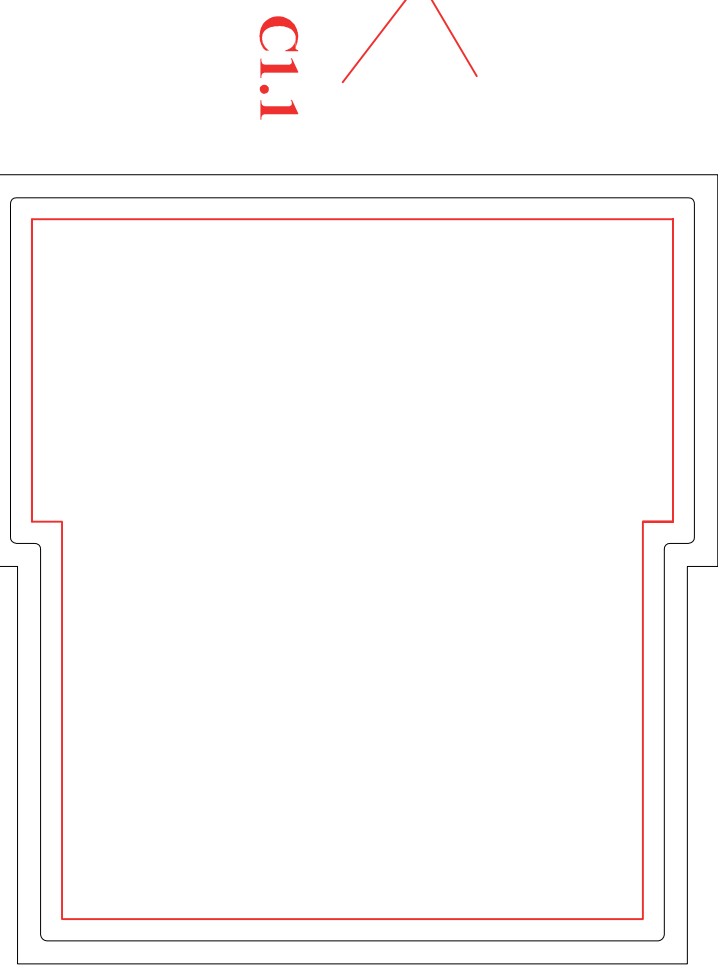

C1.1

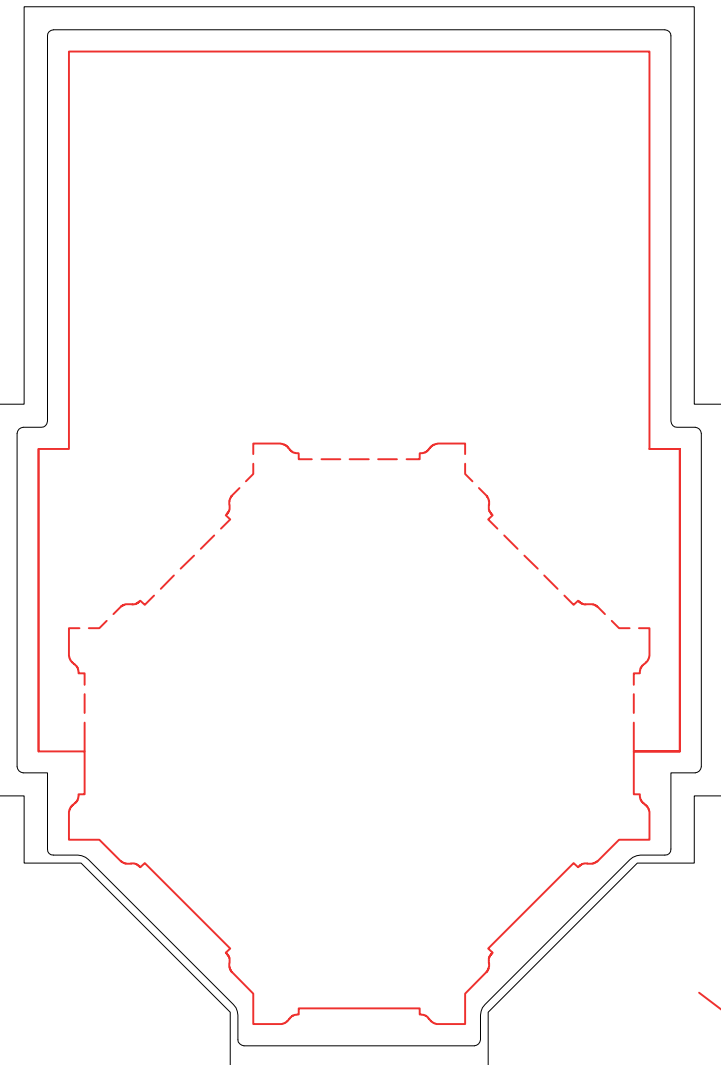

C2.1

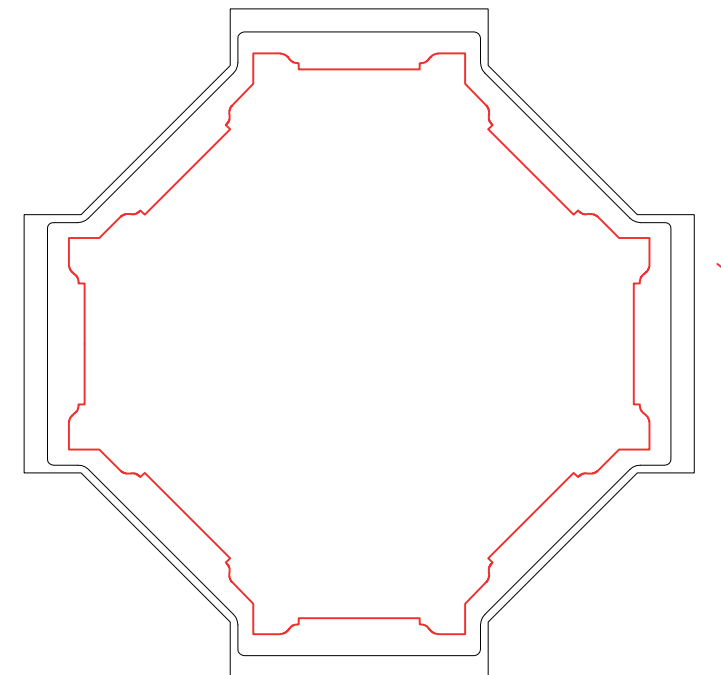

C3.1

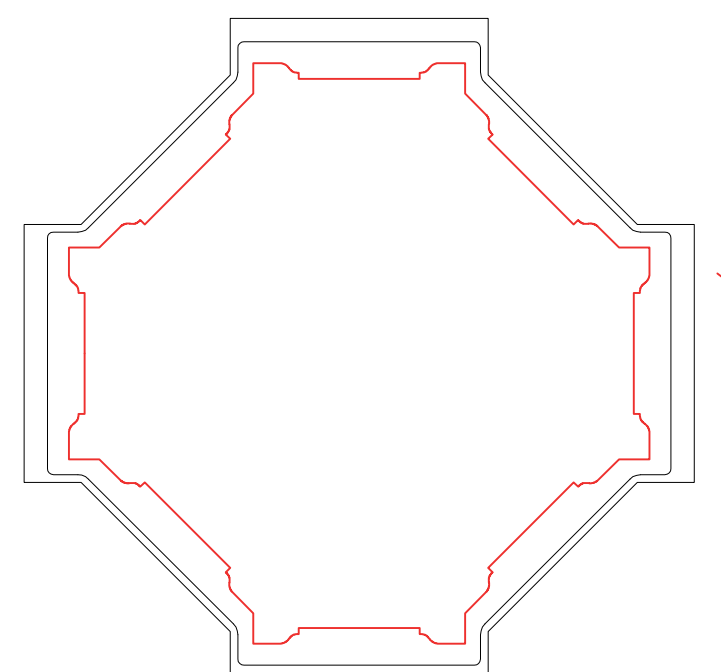

C4.1

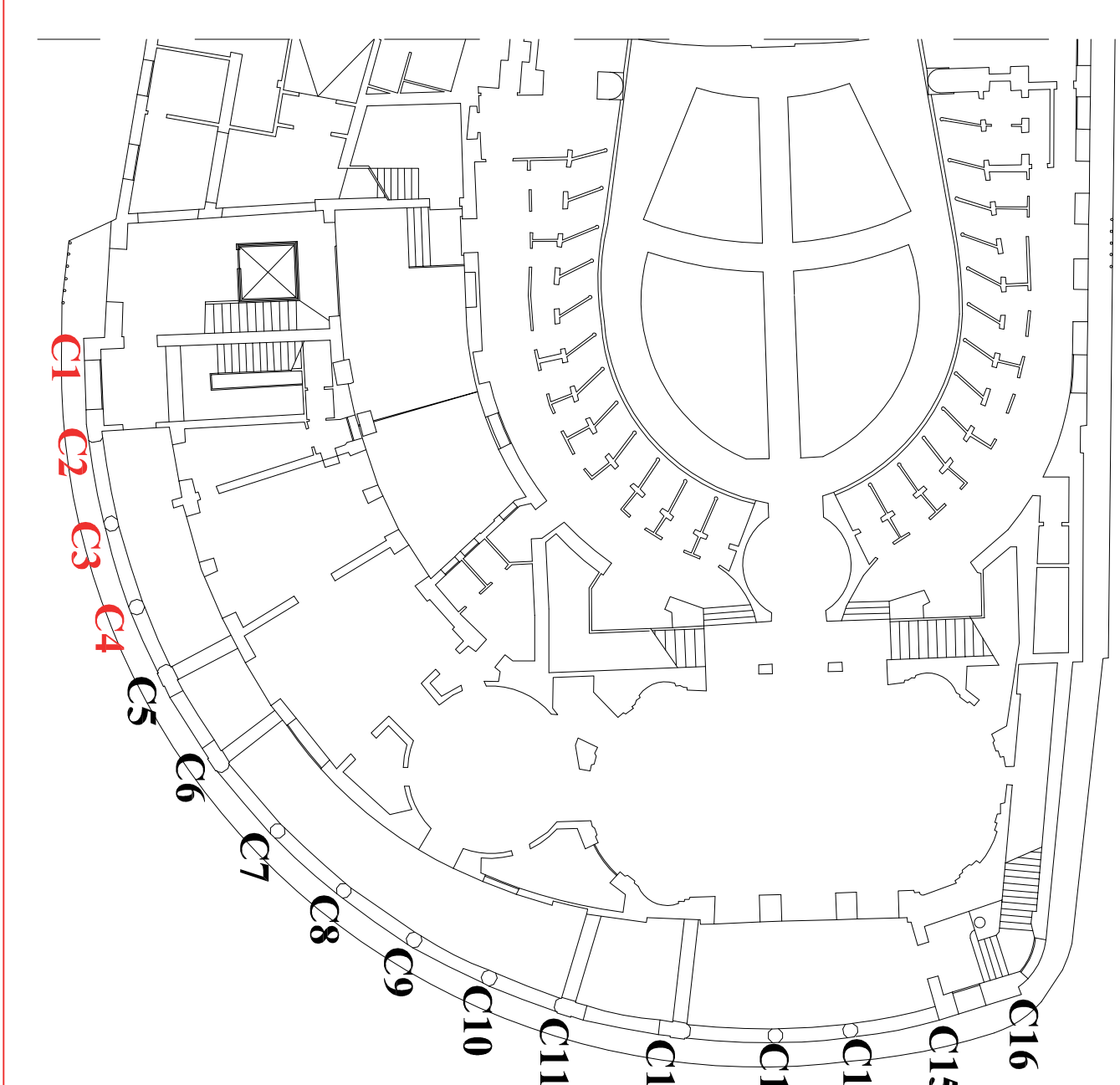

C1.2

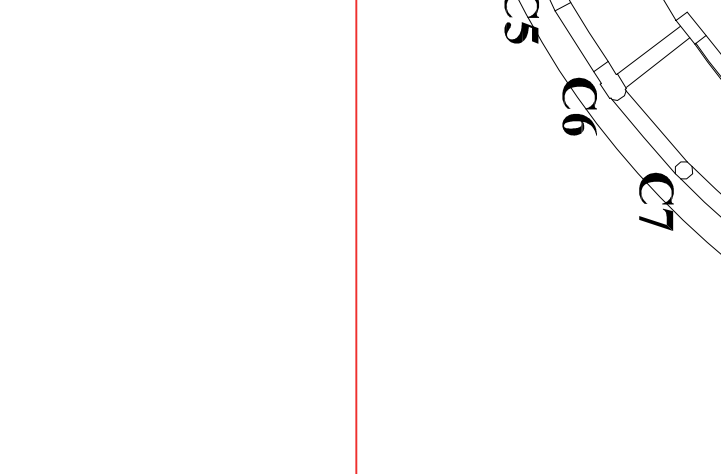

C2.2

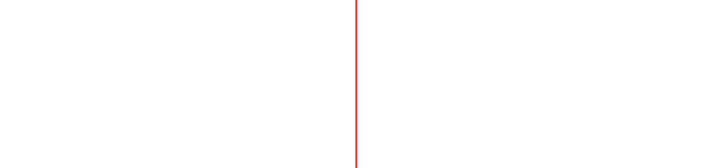

C3.2

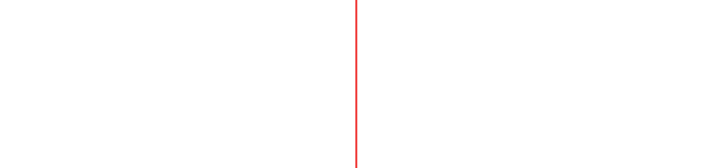

C4.2

Pianta