

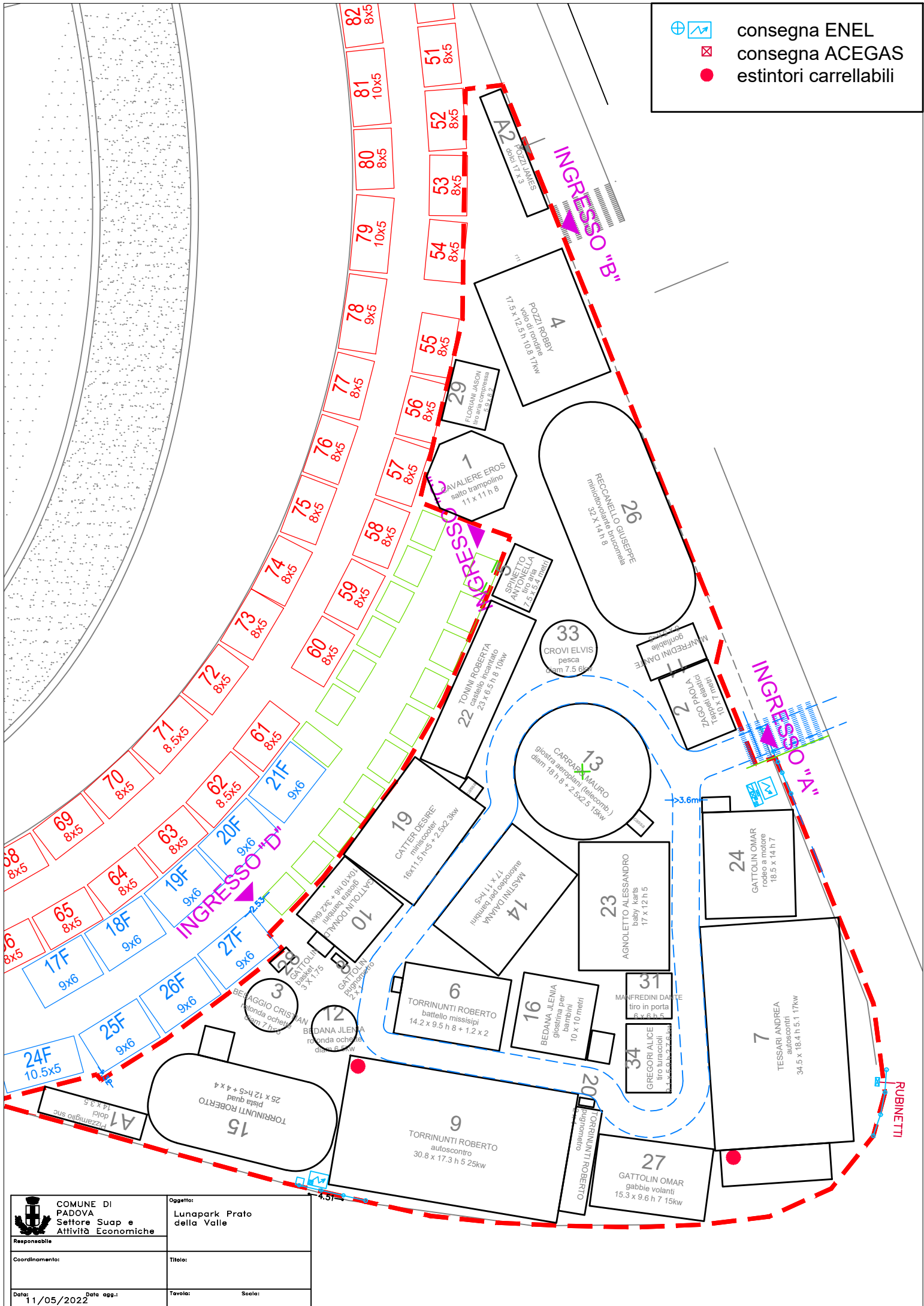

-  consegna ENEL
-  consegna ACEGAS
-  estintori carrellabili



 COMUNE DI PADOVA Settore Suap e Attività Economiche	Oggetto: Lunapark Prato della Valle	
	Responsabile:	Titolo:
Coordonamento:	Tavola:	Scala:
Data: 11/05/2022	Data agg.:	